

IQ500, Washing machine, front loader, 10 kg, , White
WG56G2Z0GB



Outstanding laundry performance with speedPack L for fast washing and automatic stainRemoval to avoid manual pre-treatment.

- ✓ speedPack L: speed up your cycle, or wash clothes in just 15 minutes.
- ✓ stainRemoval system: removes four types of stubborn stain without pretreatment.
- ✓ Our new 10kg Washing machines provide more capacity for your individual laundry needs.
- ✓ Best Energy Efficiency label A - Our most energy-efficient washing machines.
- ✓ smartFinish: smooth away creases to cut down on ironing.

Features

Technical Data

Energy Efficiency Class¹: A
Weighted energy consumption in kWh per 100 washing cycles of eco 40-60 programme: 51 kWh
Rated capacity, in kg, for the eco programme at full load (EU 2017/1369): 10.0 kg
The water consumption of the eco programme in liters per cycle: 52 l
Duration of eco 40-60 programme in hours and mins at rated capacity: 3:50 h
Spin-drying efficiency class of eco 40-60 programme: A
Airborne acoustical noise emission class: B
Airborne acoustical noise emissions : 74 dB(A) re 1pW
Built-in / Free-standing: Freestanding
Dimensions of the product: 845x598x590 mm
Weight: 78.5 kg
Connection Rating: 2300 W
Fuse protection: 10 A
Nominal power: 220-240 V
Frequency: 50-60 Hz
Length electrical supply cord: 210.0 cm
Door hinge: Left
Wheels: No
EAN code: 4242003960820
Installation type: Freestanding



Optional accessories

WX975600	Floor securing component
WZ10131	Extension for cold water inlet /Aquastop
WZMPF10	Microplastic Filter
WZWP20W	Platform with pull-out, washer, cubic

¹ Scale of Energy Efficiency Classes from A to G

IQ500, Washing machine, front loader, 10 kg, , White WG56G2Z0GB

Features

Performance

- Energy Efficiency Class¹: A
- Energy² / Water³: 51 kWh / 52 litres
- Load capacity: 1 - 10 kg
- Programme duration⁴: 3:50 h:min
- Spin drying efficiency class: A
- Spin speed^{**}: 0 - 1600 rpm
- Noise level: 74 dB (A) re 1 pW
- Noise efficiency class: B

Programmes/functions

- Standard programmes: cottons, easy care, delicates, wool hand wash
- Special programmes: drum clean with reminder, shirts/blouses, Outdoor, drain / spin, mixed fabrics, single rinse, rapid 15 minute quick wash, Hygiene

Key features

- varioSpeed: Up to 65% reduced washing cycle ***
- autoStain removal system (ASR) - 4 stain removal options at the touch of a button
- Touch control buttons: less ironing, Ready in, stain selection, start/pause with reload function, temperature selection, varioSpeed, prewash, spin speed selection, Water & Rinse Plus/Rinse Hold

Additional features

- Reload Function: Stop the washing machine to add any forgotten items of laundry to the drum.
- Large LED-Display for programme status indication, max. spin speed, remaining time and 24 h end time delay and load recommendation
- Drum volume: 70 litres
- Usage meter: counts completed programmes
- drum interior light
- waveDrum: for highly effective and extremely gentle laundry care
- drum clean with reminder function
- Large Liquid-chrome matt, black door with 165° opening and 32cm porthole opening
- Reload facility
- iQdrive with 10 year warranty
- EcoSilence drive with 10 year warranty
- waterPerfect Plus: for efficient use of water even with small loads thanks to intelligent sensor technology.
- autoStain removal system (ASR)
- antiVibration Design - for more stability and quietness
- Aqua Protection
- soft dial
- Foam detection system
- Out of balance load adjustment
- Electronic child safety package
- Acoustic signals: Buzzer
- Detergent dispensing: easy clean
- Divider for Liquid Detergent

Technical Information

- Slide-under installation
- Dimensions (H x W): 84.5 cm x 59.8 cm
- Appliance depth: 59.0 cm
- Appliance depth incl. door: 63.6 cm
- Appliance depth with open door: 107.3 cm

¹ Scale of Energy Efficiency Classes from A to G

² Energy consumption in kWh per 100 cycles (in programme Eco 40-60)

³ Weighted water consumption in litres per cycle (in programme Eco 40-60)

⁴ Duration of Eco 40-60 programme

** Values are rounded.

*** Comparison between the program duration of Easy-care 40°C and the program duration of Easy-care 40°C + activated varioSpeed option

IQ500, Washing machine, front loader, 10 kg, , White WG56G2Z0GB

Dimensioned drawings

Measurements in mm

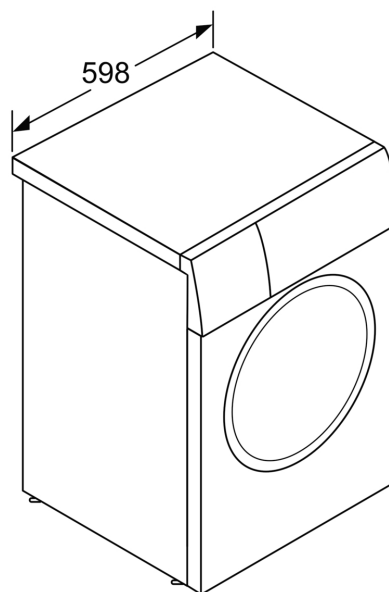
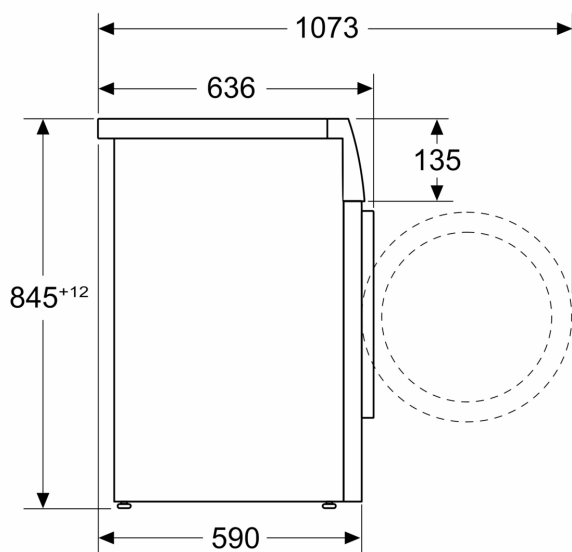

measurements in mm